

BLACKBELT®

- Fact sheet 2021 - Why limit yourself? -

It is time for limitless printing! Enjoy the maximum flexibility by printing long prints from zero cm to any length you want. Our belt technology allows you to print the same object multiple times or different objects one after the other. No more removing an object before printing the next. Your projects will be finished faster. Printing under an angle allows you to print overhangs without horizontal overhangs, thus using less filament and less time spend after processing.



Available from € 9.500,-

Blackbelt Package includes:

- Basic operator training
- Blackbelt Cura
- Support on remote
- Run-out sensor
- Blackbelt Server
- Spool holder
- 1 spool of filament
- Individual Print heads;
 - 3 x Bowden
 - 1 x varioDrive

The current **Blackbelt 3D printer** is the result of three years of continuous development and improvement. A development that originated from a basic idea and wish to be able to print on a belt. The patented¹ technology is now used by a wide range of professional customers. Our customers use the printer for exploration and discovery purposes (e.g. universities technical & medical), proto types of seals and profile, jigs & fixtures (e.g. process industries), spare parts and general prototyping for various industries.

¹ been granted in NL, pending in others economic territories

Limitless

Long parts



None stop

Serial production

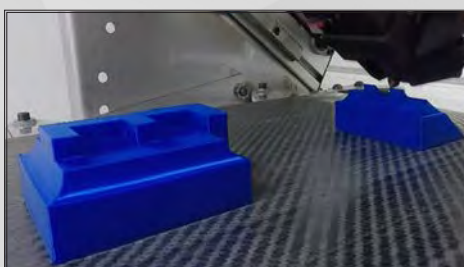

Time saver

Less support construction



E-mail: Info@blackbelt-3d.com

Phone: +31 (0)77 33 33 790

www.blackbelt-3d.com



Product Portfolio

All versions have the option to choose for a standard **Bowden** or **varioDrive** option.
Comes by default with print heads and 1 spool of nGen copolyester / varioShore

Technical Details

Print volume (max)

340 x 300 x ∞ mm

Travel speed (max)

150mm/s

Accuracy

+/- 0.4mm

Layer height

0.05 - 0.8mm

Bed temperature

140 ° C max.

max. Print temperature

300 ° C max.

Power requirements

120 - 240 V AC

Power supply

600w 24v

Dimensions

Printer

59 x 105 x 66 cm

Packaged

80 x 120 x 50 cm

Printer weight

45 kg

Printed packaged

88 kg

Warranty

Guarantee 2 years,
excluding wear parts
(print head & belt)

Maintenance

Minimal required.
Maintenance contracts are
available.

Print heads

Bowden

0.25, 0.4, 0.6,
0.8, 1.0 mm

varioDrive

0.4, 0.6, 0.9, 1.2 mm

Desktop Version

€ 9.500,-²

- Blackbelt 3D printer

Stand Alone Version

€ 10.700,-

- Blackbelt 3D printer

- Support Frame

Roller Table Version

€ 12.500,-

- Blackbelt 3D printer

- Support Frame

- Roller Table

² Prices are excl. VAT

Blackbelt Bowden or varioDrive
(*explanation on page 3*)

Carbon
Conveyor belt

Spool holder
(*small*)

Blackbelt Cura Included
Regularly provided updates

Roller Table

Makes it possible to
print in lengths of
2.5 meters

€ 1.800,-

Support Construction
Helps you working on a
ergonomical height.

€ 1.200,-

Supported Materials

- nGen copolyester
 - PETG
 - PLA / LW PLA
 - TPU Cheetah
 - ASA
- varioDrive supported**
- colorFabb TPU varioShore
 - NinjaTek Flex
 - NinjaTek Chincilla
 - colorFabb PA-CF

Bowden vs varioDrive

When you order your printer you can choose between Bowden or varioDrive.

The **Bowden configuration** consists of brass and hardened steel nozzle printheads. The Bowden works well with rigid (> 95 A) materials and is best suited when using materials that are fiber filled or materials that are very abrasive due to added particles (steel, bronze, ceramics, etc).

The **varioDrive configuration** is developed for flexible (< 95 A) materials. It works perfectly with TPU vario-Shore (light weight and foaming) material developed by colorFabb³. It also performs well with nylon carbon filled materials without switching the nozzle.

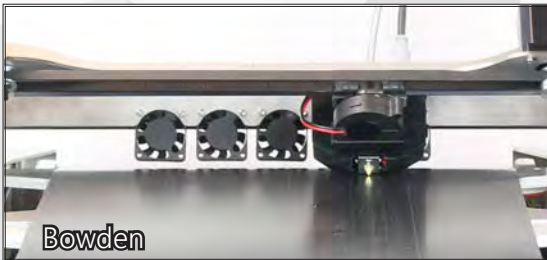

³ colorFabb is a filament producer which offers several unique light weight foaming filaments

Infill structures

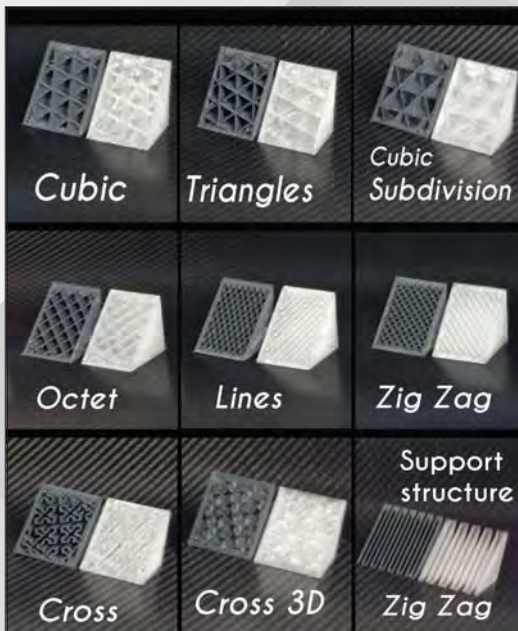

The Benchmark in 3D Belt Printing

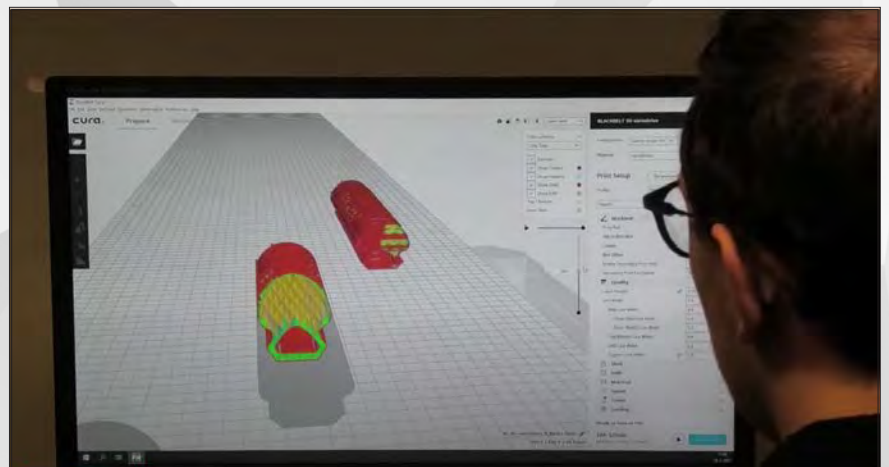

Design guidelines

The 3D geometry that needs to be printed must match our design guidelines.

The design guidelines are:

- Every geometry must start on the conveyor belt.
- From there the geometry can build up along the belt and upwards onto already printed layers.
- If the geometry does not allow this, we need to add support materials.
- The maximum dimensions are 340 mm in width and 300 mm in height and a unique endless Z length.

We can only print with certain materials.

Data sheets of the supported materials can be found on our website:

<https://blackbelt-3d.com/material-data>

Please contact team Blackbelt 3D to evaluate your 3D files on printability.

Inspiring prints - Long parts, Series, Flexibles & Others

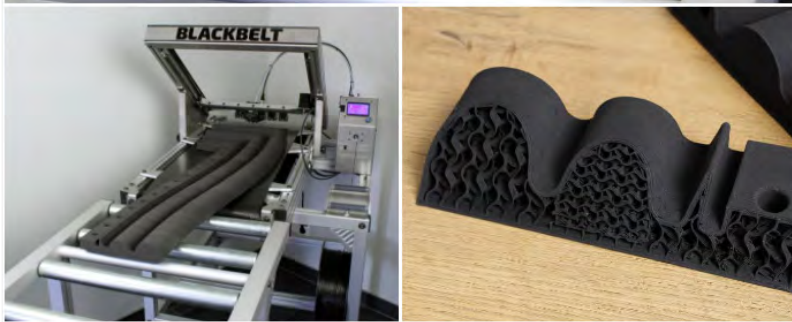
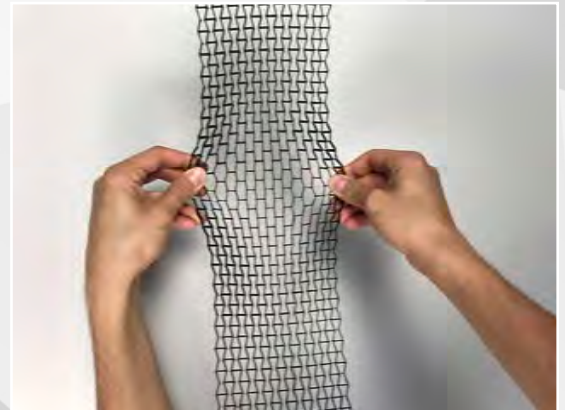
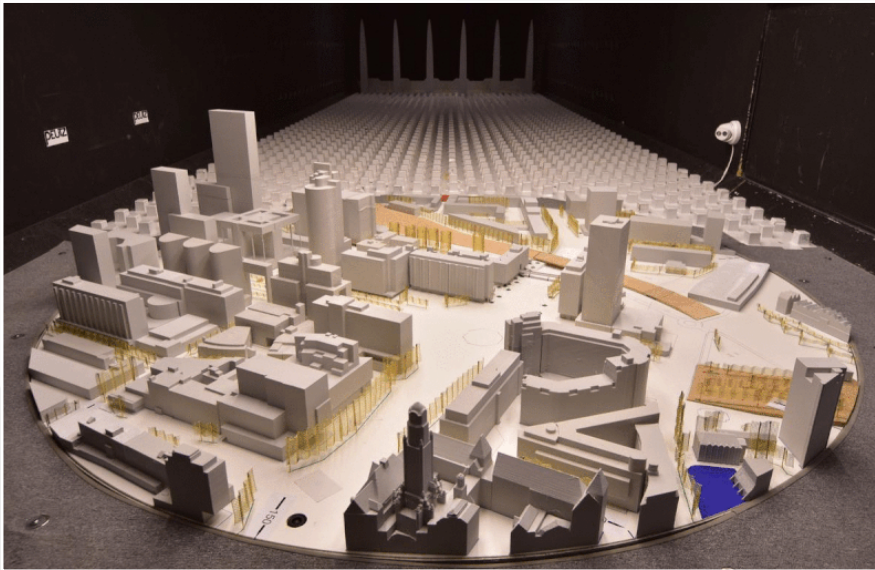

E-mail: Info@blackbelt-3d.com

Phone: +31 (0)77 33 33 790

www.blackbelt-3d.com

